

CABIN	
AROW Documents and LSA Waiver	In A/C
Ignition Switch	Off
Hobbs Meter	Check and Note
Flaps	Lower for Inspection

EMPENNAGE	
Surface and Tail Skid	Undamaged
Antennae	Secure
Horizontal Stabilizer	Secure
Elevator movement/security	Check
Elevator Trim Tab movement/security	Check
Vertical stabilizer	Secure
Rudder security/movement Check bolt security on vertical, horizontal hinge points Check pushrod locknut for elevator and elevator trim tab	Check

RIGHT WING	
Flap Deflection, Hinge and Pushrod Security	Check
Wing Surface Condition	Undamaged
Fuel Sump	Check Color/Water
Aileron Deflection, Hinge and Pushrod Security	Check
Wingtip/Strobe/Fuel Vent	Undamaged and Clear
Wing Leading Edge	Undamaged
Fuel Cap	Visually Check Level and Security
Main Gear/Brake Lines/Pants	Check
Tire Inflation and Condition	Check

ENGINE COWLING	
Canopy Attachment and Condition (Right Side)	Check
Nose Gear/Control Rods/Pants	Check
Tire Inflation and Condition	Check
Cowling Fasteners	Secure
Air Intakes and Radiators	Clear
Prop/Spinner	Check For Nicks/Cracks
Exhaust	Secure
Coolant Level	Between MIN and MAX in Overflow Bottle
Oil Level	Check (Burp if Cold)
Canopy Attachment and Condition (Left Side)	Check

LEFT WING	
Main Gear/Brake Lines/Pants	Check
Tire Inflation and Condition	Check
Fuel Cap	Visually Check Level and Security
Wing Leading Edge	Undamaged
Pitot Static Tube	Check Clear
Landing Light Condition	Check
Wingtip/Strobe/Fuel Vent	Undamaged and Clear
Aileron Deflection, Hinge and Pushrod Security	Check
Fuel Sump	Check Color/Water
Wing Surface Condition	Undamaged
Flap Deflection, Hinge and Pushrod Security	Check

BEFORE ENGINE START		
Pre-flight Check – Wt. and CG Check – Briefing		Complete
Safety Harness		Check and Fasten
Control Stick		Free
Rudder Pedals		Free
Flaps		Function Check
Parking Brake		Off/Down
Switches	(except GEN and AUX GEN always on)	Off
Circuit Breakers		In
Carb Heat		Off
Throttle		Idle
Master Switch		On
Fuel Gauge Indicators	Verify Fuel Quantity Matches Visual	Check
Fuel Selector		LEFT or Best Tank
Fuel Pump		On - Verify Fuel Pressure - Off
Choke		As Necessary
Brakes		Apply
Beacons		On
Prop Clear		Check / Call
Key-Ignition		Start
Throttle		Smooth at 2000RPM for 2 min. Then 2500RPM
Canopy		Down/Unlocked
Avionics / ADI / IC		On
Oil Pressure / Fuel Pressure		Check
Fuel Flow		Check Left, Check Right
GPS		Enter

TAXI CHECK		
Radio Set / ATIS		Check
Altimeter		Set
Transponder		SBY
Brakes		Check
Steering		Check
Radio Set / Taxi Clearance		Check
Taxi to Run-up Area		Slew A/C so prop wash clear of taxiway

RUN-UP / BEFORE TAKEOFF CHECK		
Brakes		Hold
Throttle		4000 RPM
Ignition Check		Left then Right then back to Both Max RPM drop 350, Max RPM difference 120
Carb Heat Check	Verify RPM drop of approximately 50	On then Off
Engine Instruments		Check Operating Range
Throttle		Idle
Controls		Clear
Fuel Selector		Check LEFT or Best Tank
Trim		Neutral
Flaps		15°
Safety Harness		Tighten
Canopy		Down and Locked
Transponder		ALT
Fuel Pump		On
Radio Set / Takeoff Clearance		Check

TAKEOFF		
Flaps		15°
Choke		Off (In)
Carb Heat OFF		Check
Fuel Pump ON		Check
Throttle		MAX Takeoff Power
Rotate	$V_r = 43\text{KIAS (Flaps } 15^\circ)$	
Climb	$V_y = 56\text{KIAS (Flaps } 15^\circ)$	$V_x = 53\text{KIAS (Flaps } 15^\circ)$
Flaps UP		200ft AGL or End of Runway
Fuel Pump OFF		500ft AGL

CLIMB		
Throttle		5000RPM
	$V_y = 63\text{KIAS (Flaps } 0^\circ)$	$V_x = 55\text{KIAS (Flaps } 0^\circ)$
Engine Instruments		Check
Trim		As Needed

CRUISE		
Throttle		4000-5000RPM
Airspeed		MAX 103KIAS
Engine Instruments		Check
Trim		As Needed
Fuel Management		2 Min Level Flight for True Reading Fuel Pump ON When Switching Tanks LEFT 1 Hour – RIGHT 2 Hours – LEFT for Approach and Landing

PRE-MANEUVER CHECK		
Fuel Selector		Fullest Tank
Fuel Pump		On - Check Pressure
$V_a = 86\text{KIAS}$		Check
Clearing Turns		Perform

DESCENT		
Throttle		3000 RPM
Airspeed	$V_a = 86\text{KIAS}$	MAX 103KIAS
Carb Heat		On
Trim		As Needed
Engine Instruments	CAUTION - Undercooling	Check

ENGINE FAILURE IN FLIGHT		
Glide Speed	57KIAS (Flaps 0°)	53KIAS (Flaps 15°)
Landing Area	Determine Wind Direction – Choose – Head toward	
Altitude		Check
Fuel Pump		On
Tank Select		Switch
Ignition	Prop Spinning - BOTH	Not Spinning - START IF NO START THEN CONTINUE WITH EMERGENCY LANDING
Safety Harness		Tighten
Radio Set		Notify ATC
Transponder		7700
Fuel Pump – Fuel Selector – Ignition		Off
Flaps		30° - 50°
Master Switch		Off Before Touchdown

APPROACH / LANDING		
Radio Set / ATIS - AWOS - ASOS		Check
Altimeter / Pattern Altitude		Check
Fuel Quantity Check LEFT or Fullest Tank	2 Min Level Flight for True Reading Fuel Pump ON When Switching Tanks	
Flight Instruments		Check
Safety Harness		Tighten
Brakes		Check
Abeam the Numbers		
Throttle	Flap Operating Range	< 70KIAS
Carb Heat		On
Fuel Pump		On
Flaps		15°
Base Leg	<u>Normal</u>	<u>Short Field</u>
Throttle	55-60KIAS	50KIAS
Flaps	30°	50°
Trim		As Needed

BALKED LANDING / GO AROUND		
Throttle		MAX Takeoff Power
Flaps		15°
Carb Heat		Off
Climb	V _y = 56KIAS (Flaps 15°)	V _x = 53KIAS (Flaps 15°)
Radio		Notify Tower
Trim		As Needed
Flaps UP		200ft AGL or End of Runway
Fuel Pump OFF		500ft AGL

AFTER LANDING		
Throttle		Idle
Clear Active Runway		Check
Flaps		Up
Transponder		SBY
Fuel Pump		Off
Carb Heat		Off
Trim		Neutral
Canopy		Open for Ventilation

SHUTDOWN / SECURE AIRCRAFT		
Brakes		Hold
Avionics / ADI / IC / AP		Off
Instruments		Check
Throttle	Until Voltmeter Shows 14volts	4000RPM
Throttle		Idle
Ignition		Off
Beacons		Off
Master Switch	(except GEN and AUX GEN always on)	Off
Hobbs Meter		Check and Note
Forward and Side Canopy Vents		Close
Close and Lock Canopy		As Appropriate
Chocks or Tie Downs		As Appropriate
Canopy Cover		As Appropriate

SportStar^{plus}

SportStar^{plus}

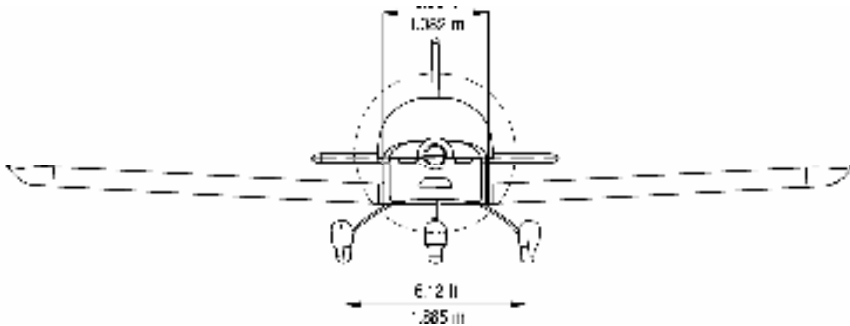
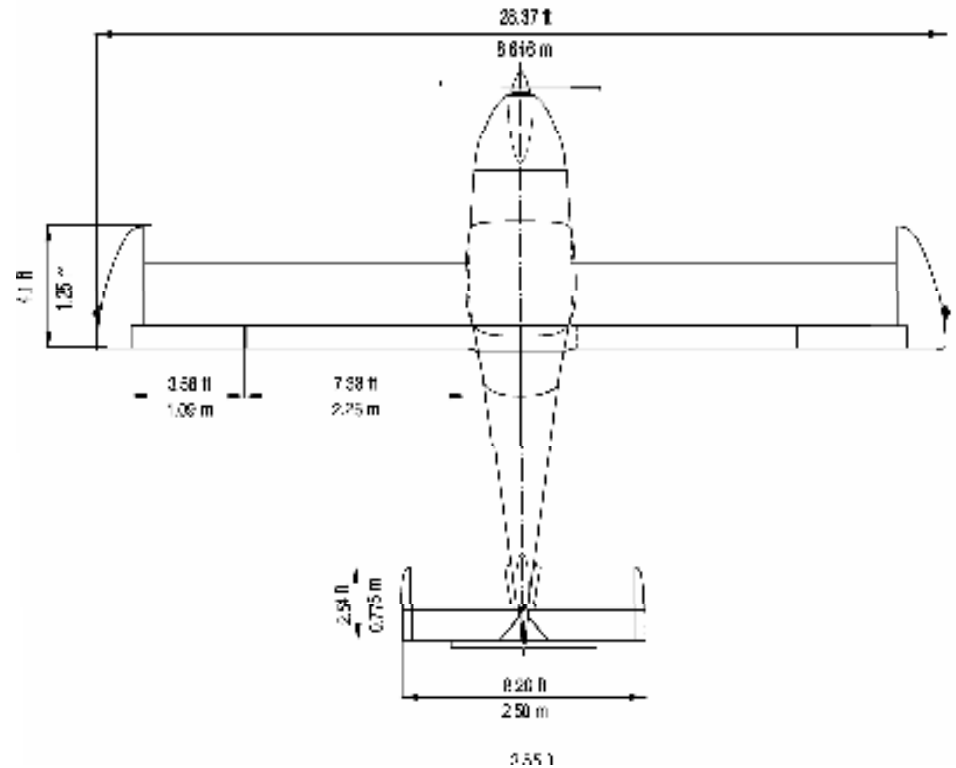
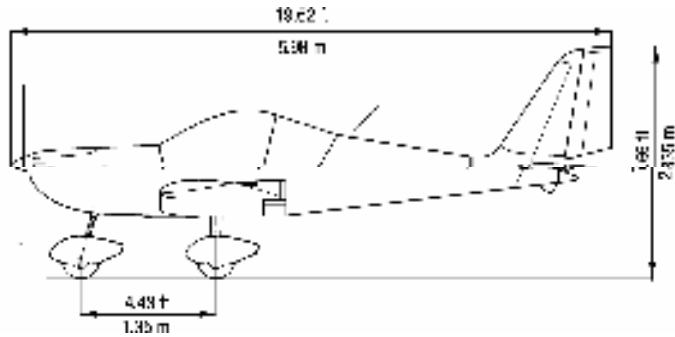

**Evektor N928CF
CHECKLIST**

**Evektor N928CF
CHECKLIST**